



PRADO
 February 2024 Production Onwards
ACRYLIC BONNET PROTECTOR
 Installation Instructions

Accessory Part No. PZQ15-60270 (Clear) / PZQ15-60280 (Tinted) Installation Time: Approx. 30 mins

Place these instructions in vehicle's glove box after installation is complete

Care Instructions:



Do not slam bonnet.



Clean Bonnet with a mild detergent and water solution.



Do not use automatic car wash.



Do not use abrasive, spirit or solvent based cleaners.

Item	Component Name	Qty	Part number
1	Bonnet Protector (Clear) or Bonnet Protector (Tinted)	1	PZQ15-60270 (Clear) or PZQ15-60280 (Tinted)
2	Fixed Clip	2	PZQ15-6027A (Clear) or PZQ15-6028A (Tinted)
	Centre Sliding Clip	2	
	Wing Clip	2	
	Screw Plug	2	
	Self-Tapping Screw	2	
	Small Screw	6	
	Washer	6	
	Anti-Abrasive Tape	8	
	Alcohol Wipe	1	
	Fitting Instruction Flyer	1	

Item	Qty	Description	Item	Qty	Description
A	2	Fixed Clip	F	6	Small Screw
B	2	Centre Sliding Clip	G	6	Washer
C	2	Wing Clip	H	8	Anti-Abrasive Tape
D	2	Screw Plug	J	1	Alcohol Wipe
E	2	Self-Tapping Screw	K	1	Fitting Instruction Flyer

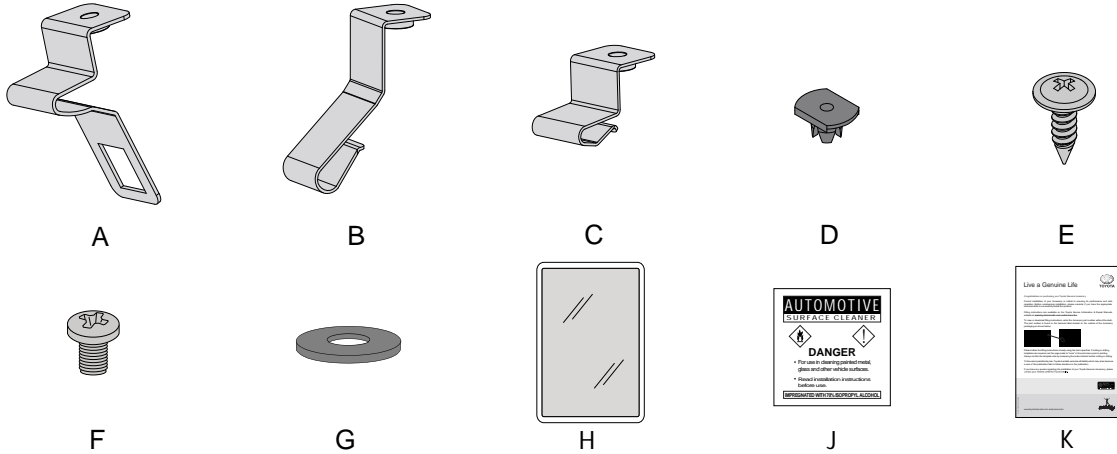

FITTING KIT
 PZQ15-6027A (Clear) / PZQ15-6028A (Tinted)

BONNET PROTECTOR
 PZQ15-60270 (Clear) /
 PZQ15-60280 (Tinted)

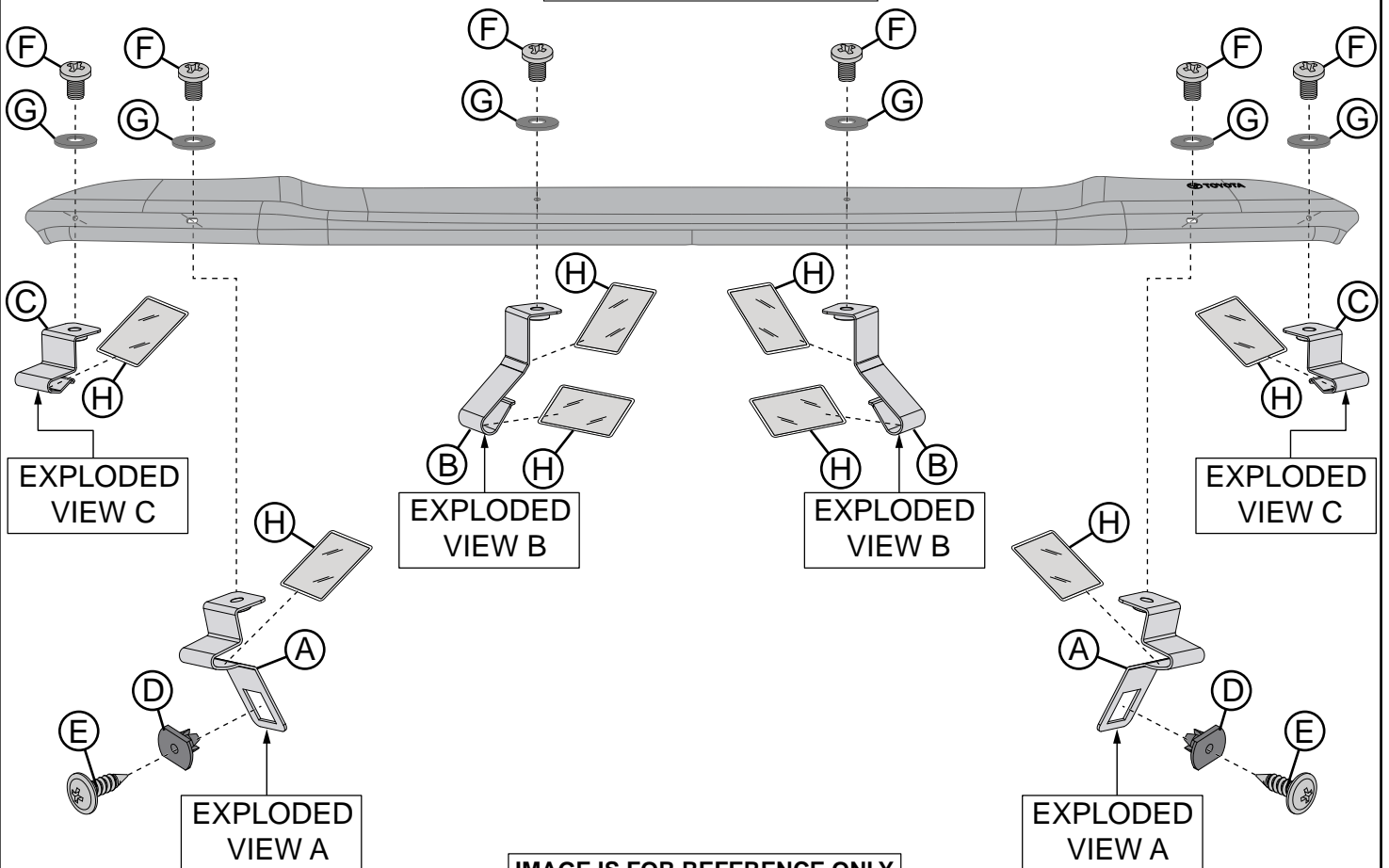

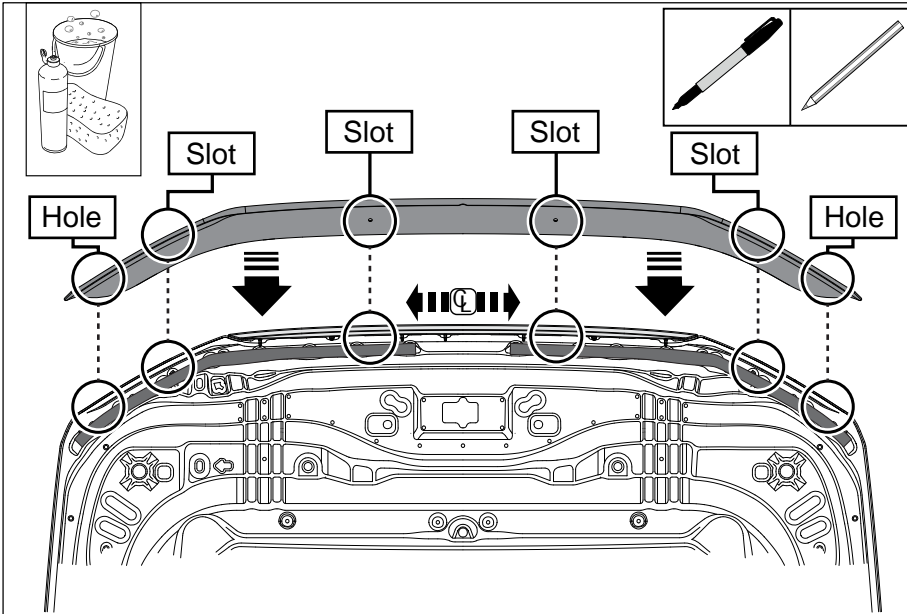
Diagram #: 1

1. Read installation instructions thoroughly before commencing installation.

Open and thoroughly clean and dry the bonnet.

Trial fit the Bonnet Protector centrally onto the bonnet.

Note and mark where the two inner slots correspond to the bonnet.

Note and mark where the two middle slots correspond to the bonnet and rubber trim in the bonnet.

Note and mark where the two outer holes correspond to the bonnet.

Remove the Bonnet Protector.
See Dia #1.

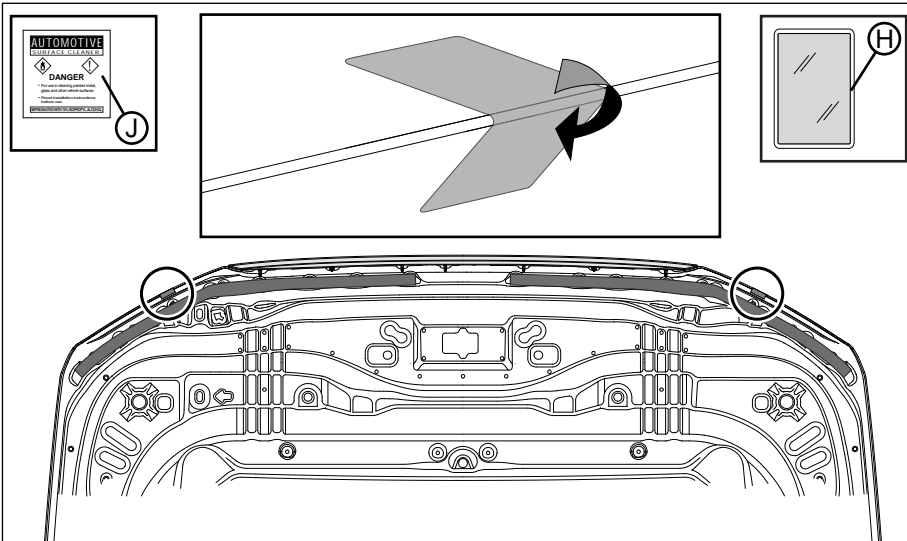
Diagram #: 2

2. Sit the Bonnet Protector back from the front lip of the bonnet.

Clean the area of the bonnet that corresponds to the two middle slots with the alcohol wipe provided.

Wipe off any residue with a clean, dry cloth.

Adhere the Anti-Abrasive Tapes over the bonnet lip at the two middle slots locations.

Apply tape so approximately half of the tape is on the topside and half is on the underside of the bonnet.

See Dia #2.

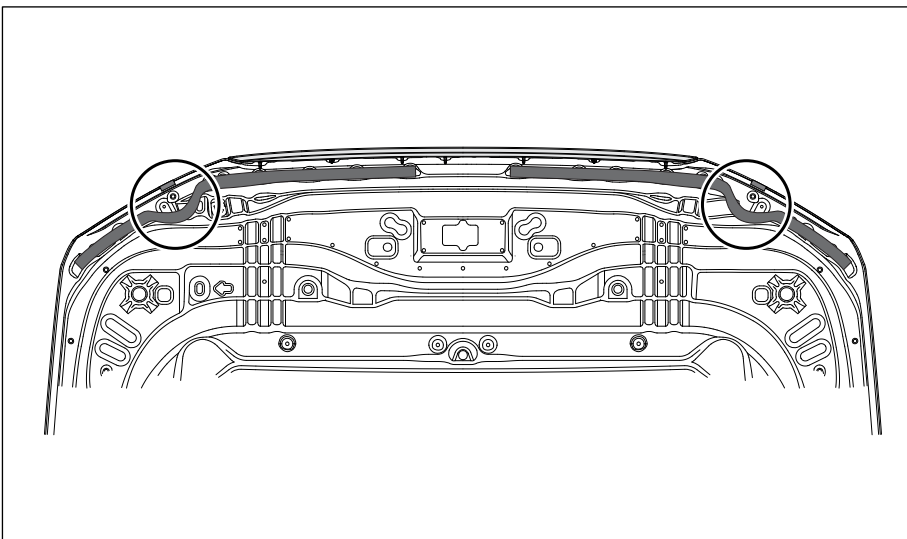
Diagram #: 3

3. On the underside of the bonnet, pull the bonnet seals out at the two Fixed Clips locations indicated.

See Dia #3.

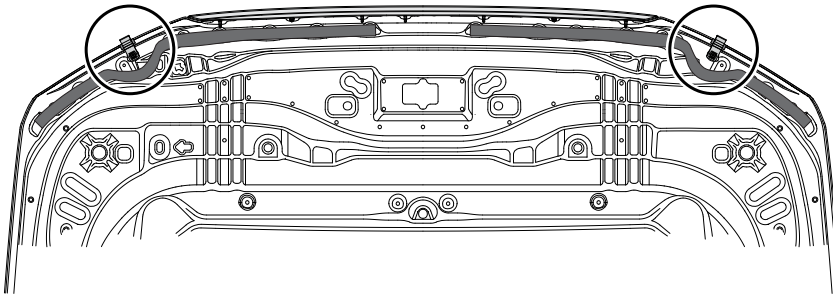
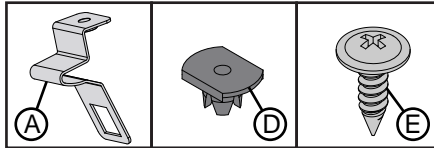
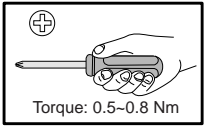

4. Slide the Fixed Clips onto the bonnet. Ensure rectangular holes on the Fixed Clips are centrally aligned with the round holes in the bonnet.

Insert the Screw Plugs through the rectangular holes of the Fixed Clips into the bonnet. Secure with the Self-Tapping Screws provided.

See Dia #4.

Note: Ensure the Screw Plug does not rotate out of the position while inserting the Self-Tapping Screw. Ensure torque setting 0.5-0.8 Nm is used.

IMPORTANT: Ensure that the clips are positioned over anti-abrasive tape and do not come into contact with any of the bonnet's paint work. Failure to do so may result in permanent paint damage.

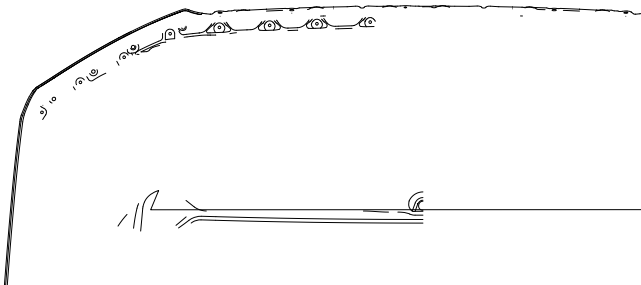

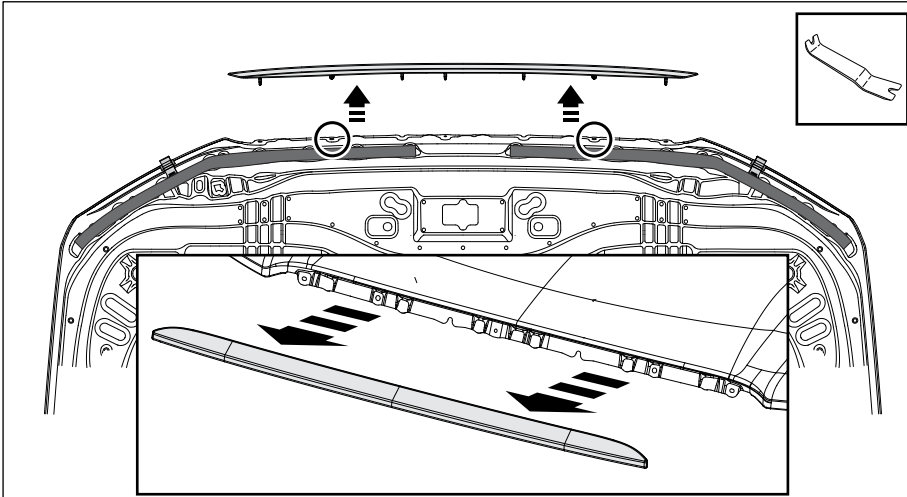

7. Remove the front plastic fascia using the moulding removal tool at the two plastic clip locations and gently pulling it away from the bonnet.
See Dia #7.

IMPORTANT: Ensure that each plastic clip on back of the plastic fascia is carefully removed without damaging at two locations.

IMPORTANT: Use the moulding removal tool without damaging the bonnet paint.

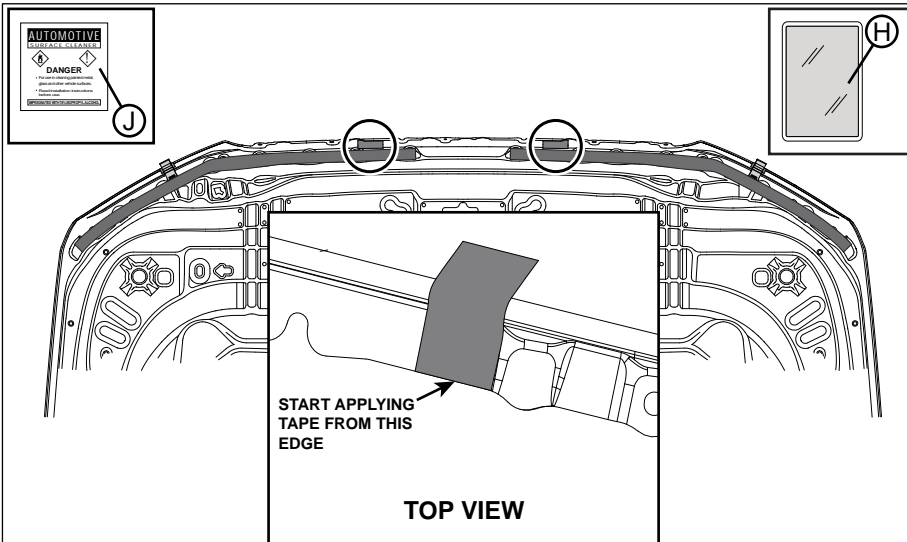
Diagram #: 7

8. Clean the top area of the bonnet that corresponds to the two inner slots with the alcohol wipe provided.

Wipe off any residue with a clean, dry cloth.

Adhere the Anti-Abrasive Tape over the bonnet lip at the inner slots locations.
See Dia #8.

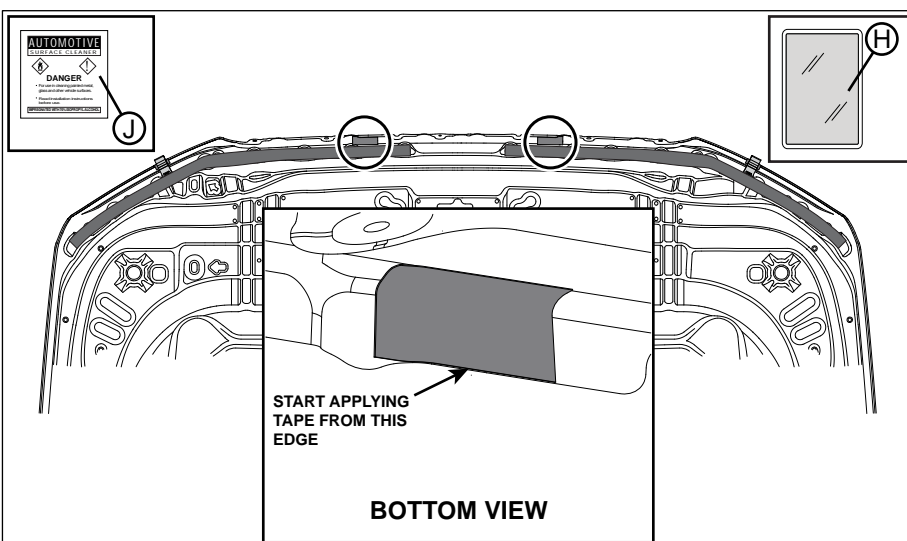
Diagram #: 8

9. Clean the underside area of the bonnet that corresponds to the two inner slots with the alcohol wipe provided.

Wipe off any residue with a clean, dry cloth.

Adhere the Anti-Abrasive Tape under the bonnet lip at the inner slots locations.
See Dia #9.

Diagram #: 9

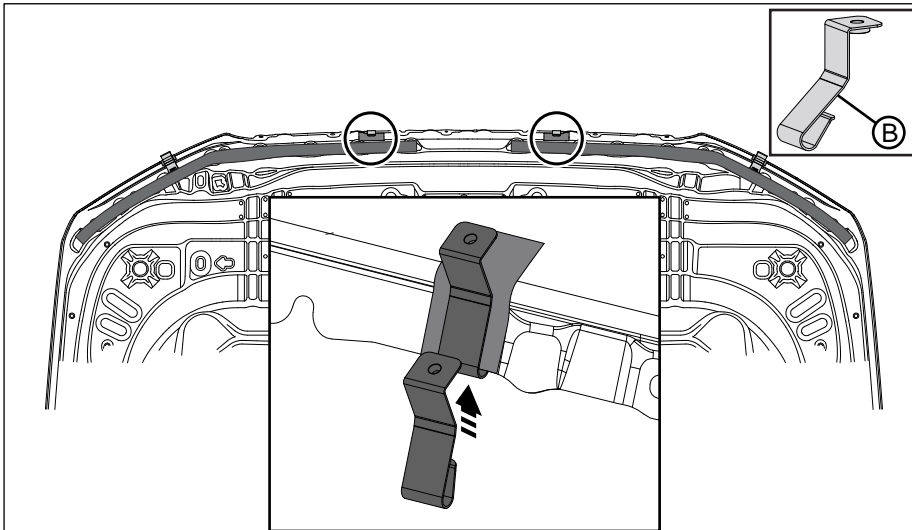

10. Slide the two Centre Sliding Clips onto the bonnet lip over the previously adhered Anti-Abrasive Tapes.

See Dia #10.

IMPORTANT: Ensure that the clips are positioned over anti-abrasive tape and do not come into contact with any of the bonnet's paint work. Failure to do so may result in permanent paint damage.

Diagram #: 10

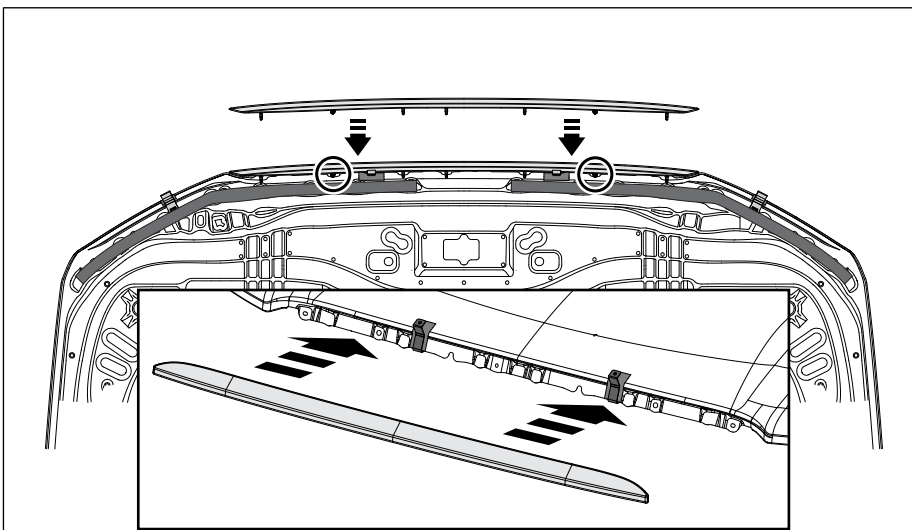

11. Re-fit the front plastic fascia by pushing the plastic clips at the two locations through the corresponding holes in the bonnet.

See Dia #11.

Diagram #: 11

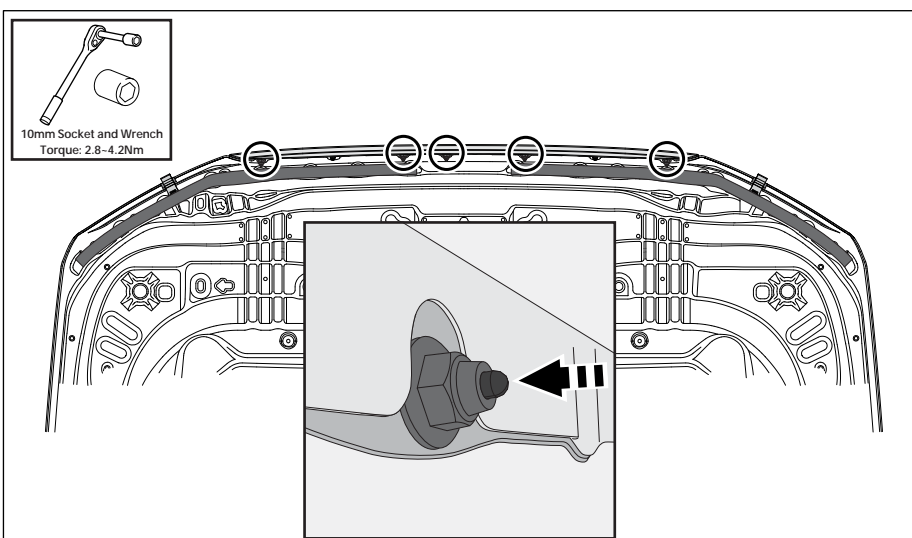

12. Secure the front plastic fascia using the metal nuts at the five indicated locations.

See Dia #12.

Note: Ensure torque setting 2.8-4.2Nm is used.

Diagram #: 12

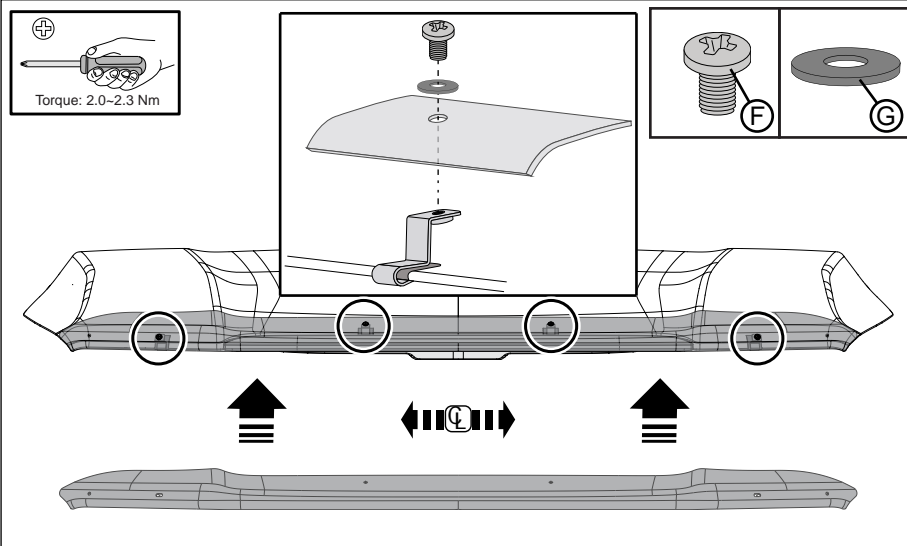

13. Re-fit the Bonnet Protector centrally onto the bonnet.

Secure the Bonnet Protector to the two Fixed Clips first and then to the two Centre Sliding Clips using the Small Screws and Washers provided.

See Dia #13.

Note: Ensure torque setting 2.0~2.3Nm is used.

Diagram #: 13

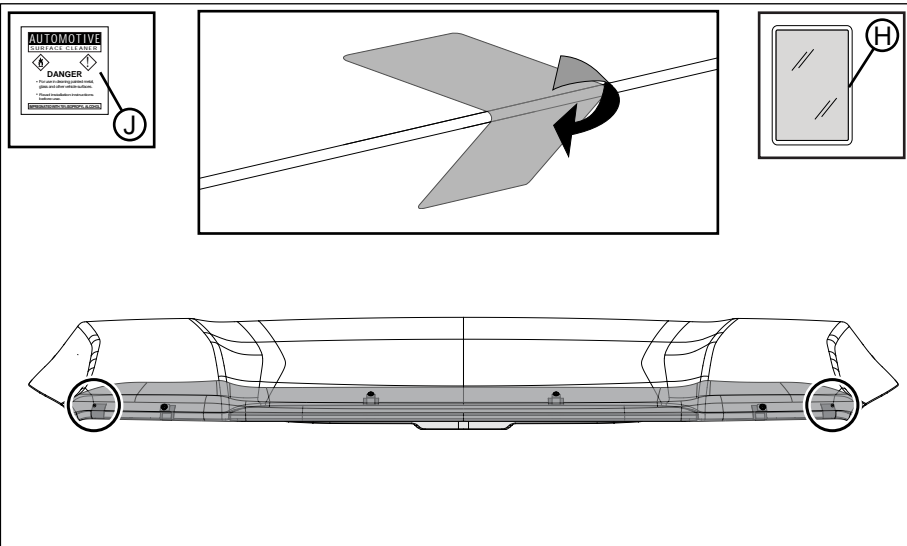

14. Clean the area of the bonnet that corresponds to the two outer holes with the alcohol wipe provided.

Wipe off any residue with a clean, dry cloth.

Adhere the Anti-Abrasive Tape over the bonnet lip at the outer holes locations.

Apply tape so approximately half of the tape is on the topside and half is on the underside of the bonnet.

See Dia #14.

Diagram #: 14

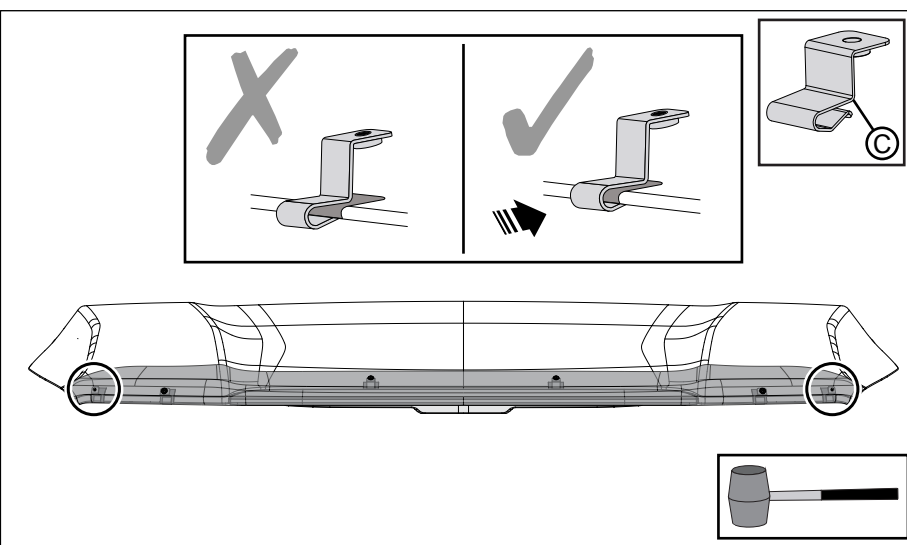

15. Slide the two Wing Clips onto the bonnet lip over the previously adhered Anti-Abrasive Tapes.

See Dia #15.

IMPORTANT: Ensure that the clips are positioned over anti-abrasive tape and do not come into contact with any of the bonnet's paint work. Failure to do so may result in permanent paint damage.

IMPORTANT: Extra amount of force might need to be applied to the clips using rubber mallet to fully engage the clips.

Diagram #: 15

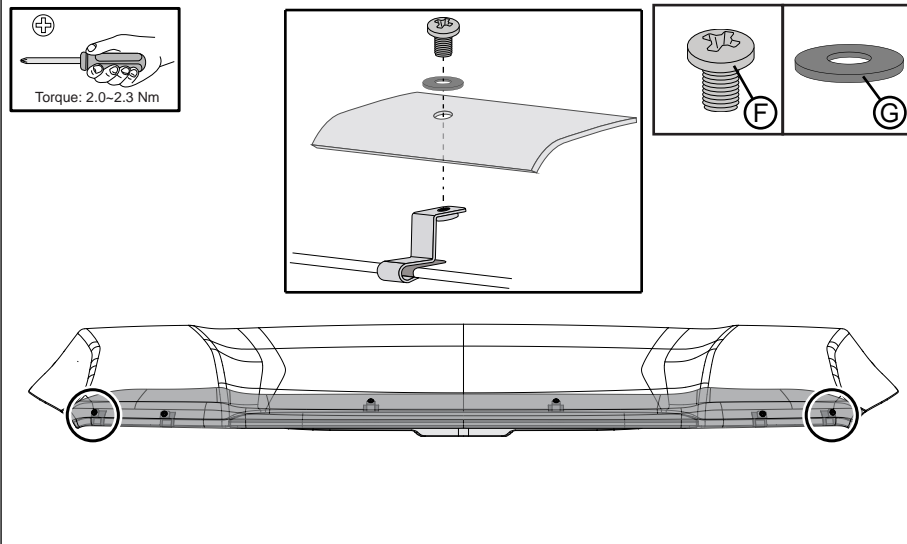

16. Secure the Bonnet Protector to the two Wing Clips using the Small Screws and Washers provided.
See Dia #16.

Note: Ensure torque setting 2.0~2.3Nm is used.

Diagram #: 16