

Kluger

December 2020 Production Onwards
ACRYLIC NOSECONE PROTECTOR
 Installation Instructions

Installation Time: Approx. 15 mins

Place these instructions in vehicle's glove box after installation is complete

Care Instructions:



Do not slam nosecone.



Clean Nosecone Protector with a mild detergent and water solution.



Do not use automatic car wash.



Do not use abrasive, spirit or solvent based cleaners.

Item	Component Name	Qty
1	Nosecone Protector (Clear) or Nosecone Protector (Tinted)	1
2	Top Metal Fixed Clip	4
	Lower Metal Clip	4
	Screw	8
	Fibre Washer (Thin)	8
	Neoprene Washer (Thick)	8
	Large Anti-Abrasive Tape	8
	Small Anti-Abrasive Tape	2
	Alcohol Wipe	1
	Fitting Instruction Flyer	1

Item	Qty	Description	Item	Qty	Description
A	4	Top Metal Fixed Clip	F	8	Large Anti Abrasive Tape
B	4	Lower Metal Clip	G	2	Small Anti Abrasive Tape
C	8	Screw	H	1	Alcohol Wipe
D	8	Fibre Washer (Thin)	J	1	Fitting Instruction Flyer
E	8	Neoprene Washer (Thick)			

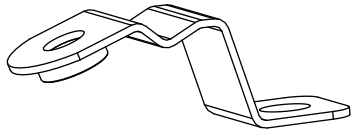

A



B



C



D



E



F



G



H



J

FITTING KIT

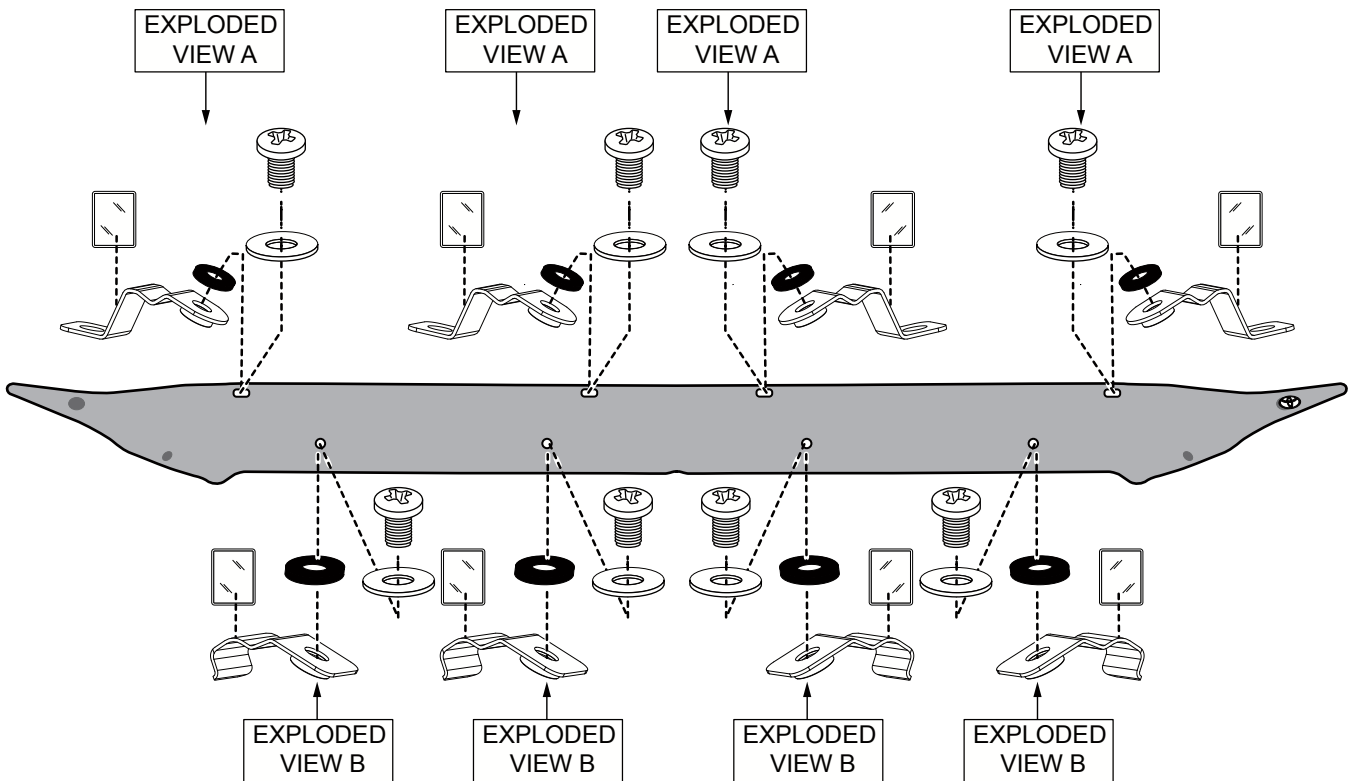

IMAGE IS FOR REFERENCE ONLY

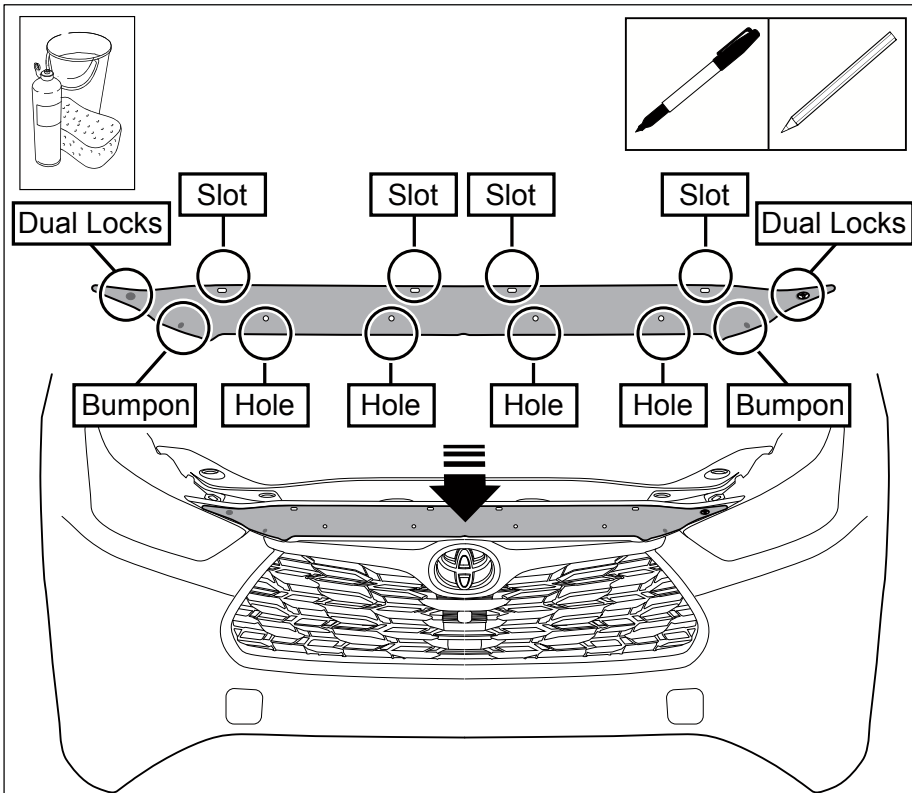

Diagram #: 1

1. Read installation instructions thoroughly before commencing installation.

Open and thoroughly clean and dry the nosecone.

Trial fit the nosecone protector centrally onto the nosecone.

Note and mark where the slots and holes correspond to the nosecone and the lower fascia.

Also note and mark where the two small bumpons and the two outer dual locks contact the nosecone surface.

Remove the Nosecone Protector.
See Dia #1.

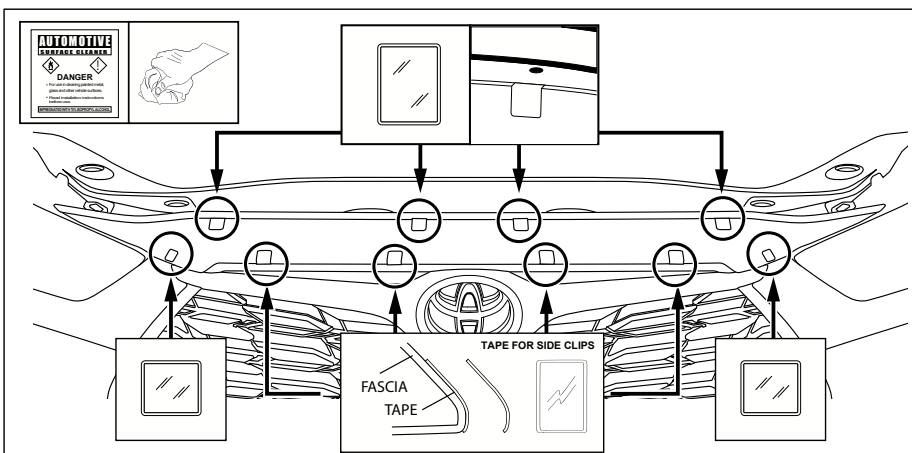

Diagram #: 2

2. Clean the eight previously noted clip positions and the two bumpon positions with the alcohol wipe provided.

Wipe off any residue with a clean, dry cloth.

Adhere the large abrasion resistant tape strips to the front of the fascia at the clip positions and the small abrasive resistant tapes to the each bumpon position.
See Dia #2.

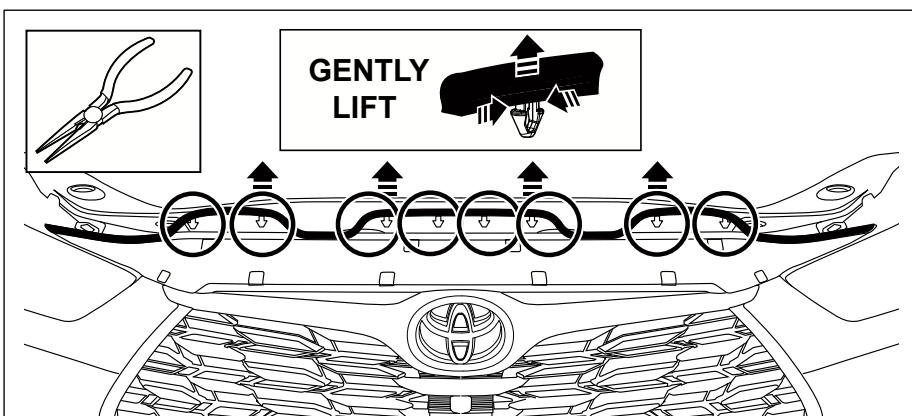
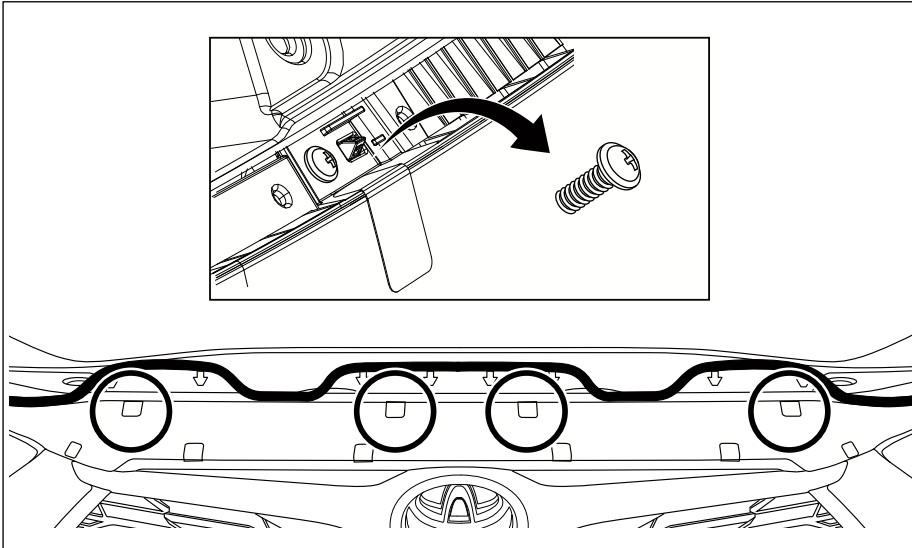

Diagram #: 3

3. Gently pry up the scrivets in the seal at each top clip location.

Take care not to damage the scrivets. Needlenose pliers may be needed to ensure the scrivets are lifted evenly and not damaged or distorted. Apply pressure inward with the pliers to release the clip.
See Dia #3.



4. Remove the screws at the four top clip positions in the vehicle and retain.
See Dia #4.

Diagram #: 4

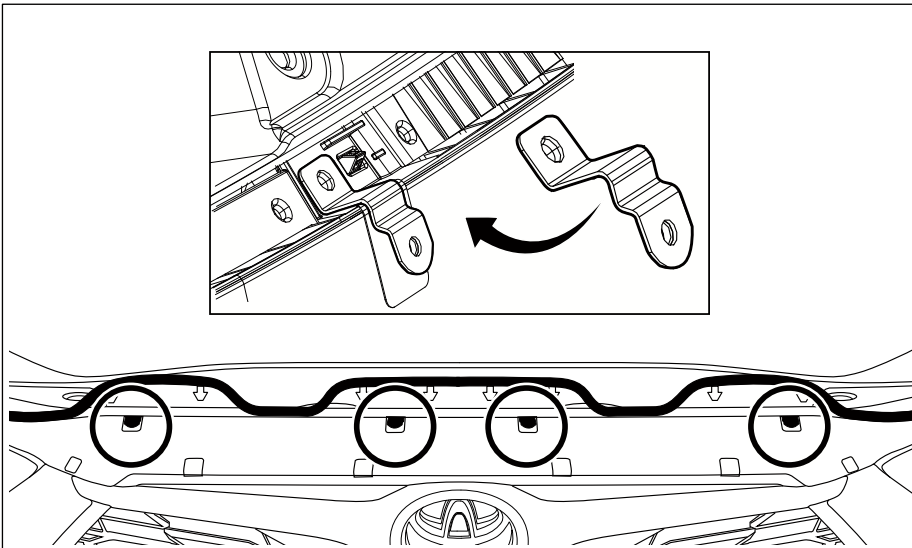

5. Install a Top Metal Clip at the four top clip positions and align the hole in the clip with the vacant screw hole in the vehicle.
See Dia #5.

IMPORTANT: Ensure that the clips are positioned over anti-abrasive tape and do not come into contact with any of the nosecone's paint work. Failure to do so may result in permanent paint damage.

Diagram #: 5

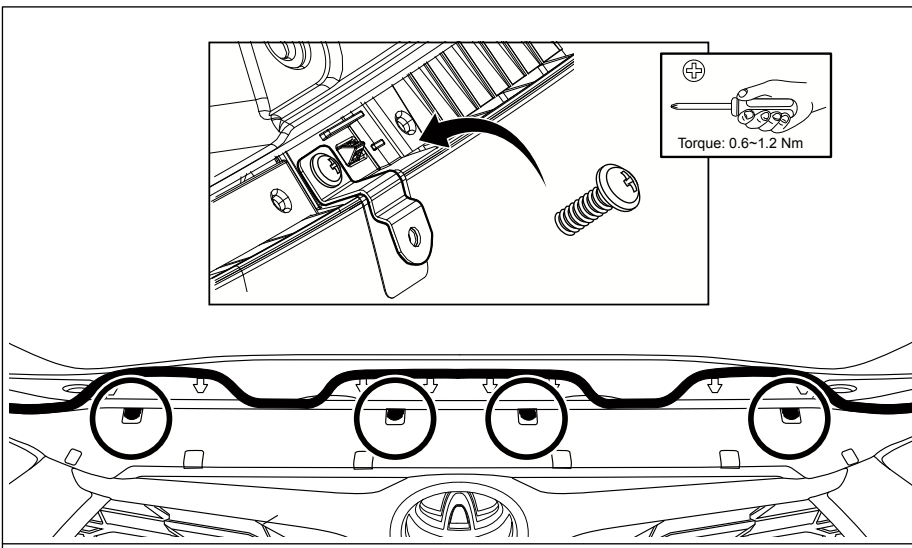

6. Re-install the retained screws through the Top Metal Clips, securing them to the vehicle.

See Dia #6.

Diagram #: 6

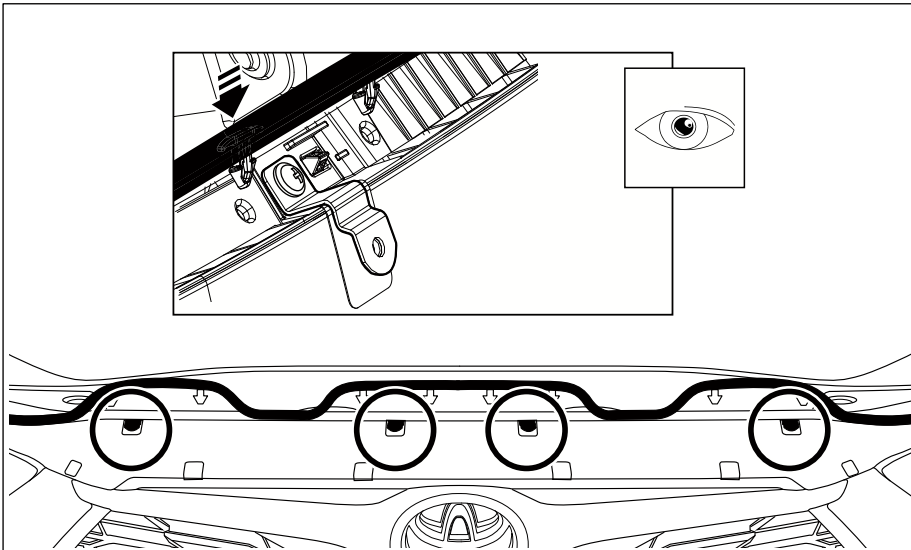

Diagram #: 7

7. Re-install the seal by pushing the scrivets in the seal into the holes in the vehicle.

See Dia #7.

IMPORTANT: Ensure that the plugs are fully clipped into the hole and check by pulling upward to ensure they are fully engaged and do not come out.

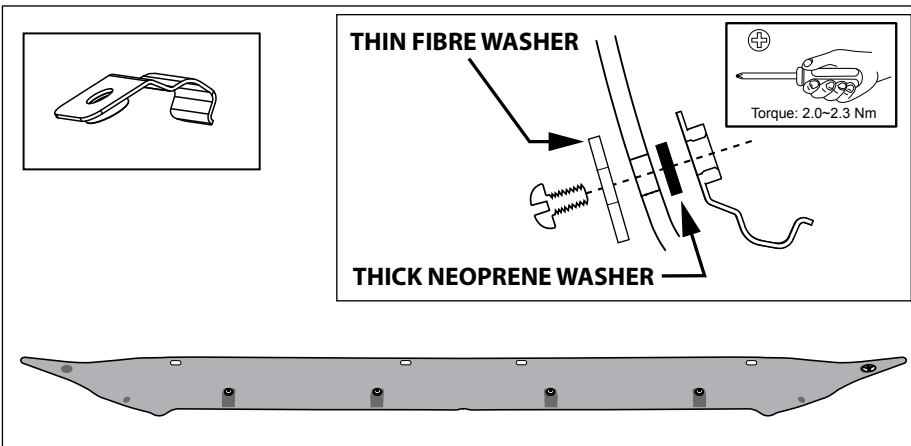

Diagram #: 8

8. Secure the Nosecone Protector to the four lower metal clips with the small screws, fibre and neoprene washers. The neoprene washers go in between the Nosecone Protector and the Metal clips.

See Dia #8.

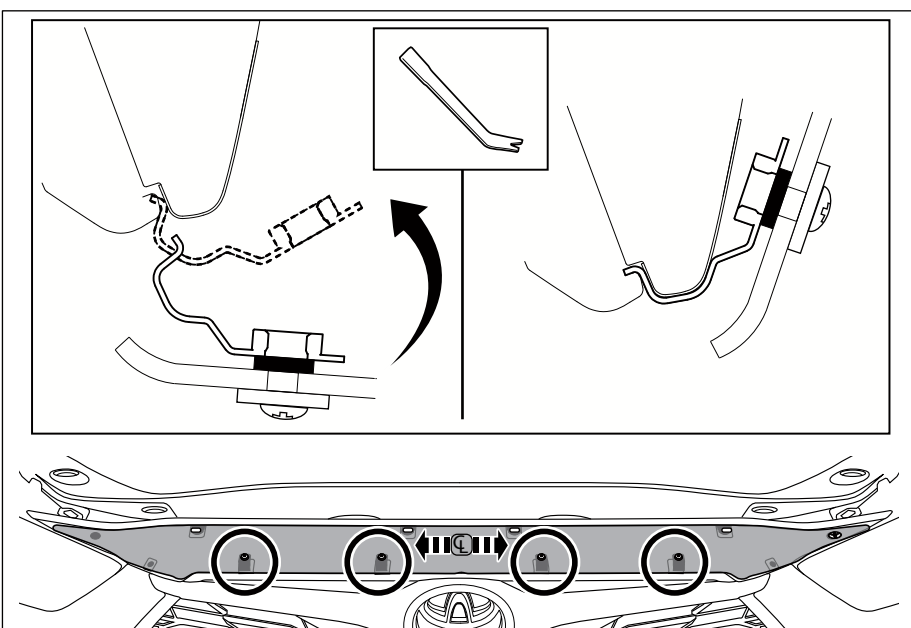

Diagram #: 9

9. Using a trim tool, pry open a gap between the nosecone and fascia, and centrally install the Nosecone Protector by inserting the four attached lower metal clips into the gap as shown.

See Dia #9

IMPORTANT: Ensure that the clips are positioned over anti-abrasive tape and do not come into contact with any of the nosecone's paint work. Failure to do so may result in permanent paint damage.

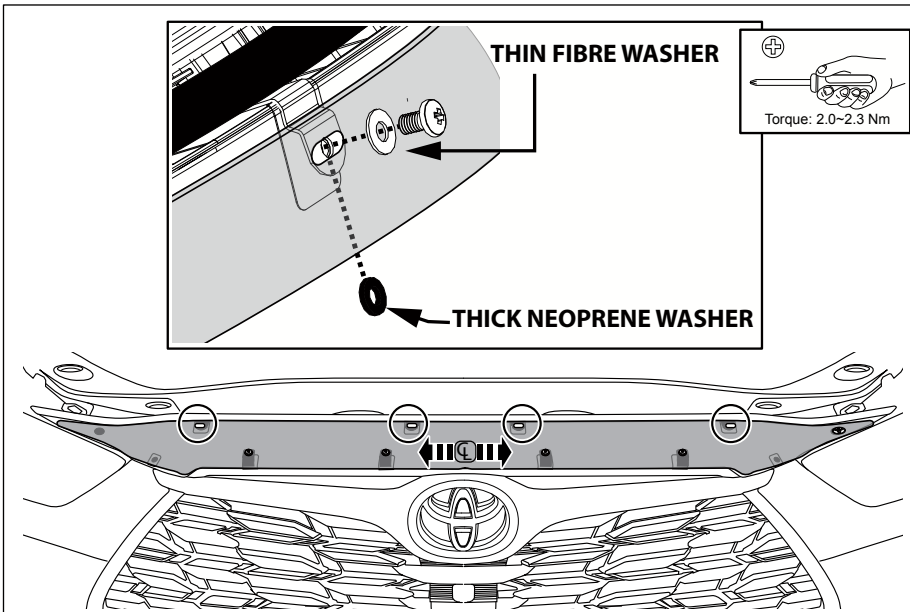

Diagram #: 10

10. Loosely secure the Nosecone Protector to the four top metal clips with the small screws, fibre and neoprene washers. The neoprene washers go in between the Nosecone Protector and the Metal clips.

Check the Nosecone Protector is sitting centrally on the nosecone. Tighten the top screws.

See Dia #10.

CAUTION

When tightening the wing clips ensure they do not rotate on the nosecone in order to prevent damage to the vehicle when the bonnet closes.

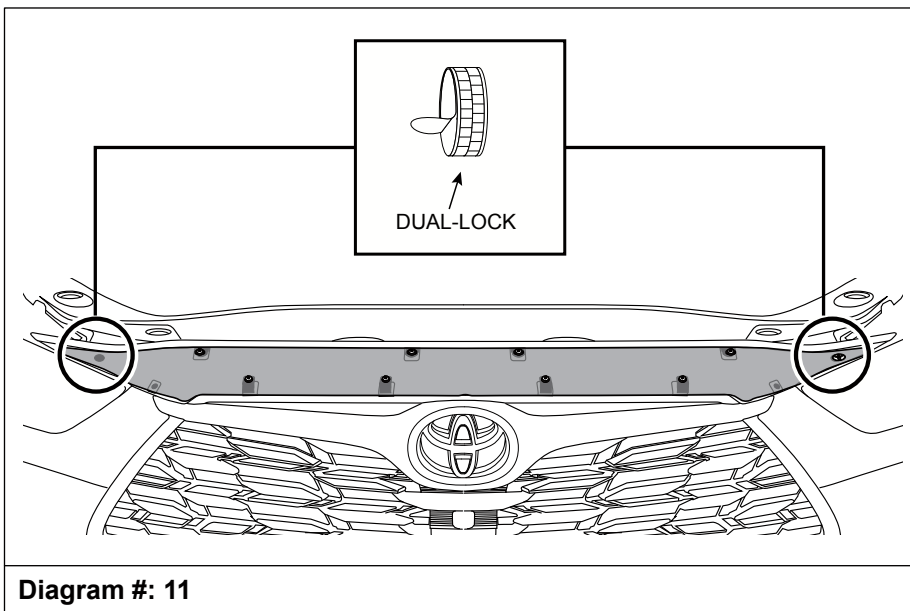

Diagram #: 11

11. At the dual-lock disc location slightly lift the Nosecone Protector, and remove the dual-lock disc backing tape.

Apply firm downward pressure to the dual lock disc to ensure that it adheres to the Nosecone.

See Fig #11.

IMPORTANT: Conduct final inspection, ensuring all screws are tightened, and clips are correctly installed and not touching the nosecone surface.

TO REMOVE : Remove screws, washers and tapes, then remove Nosecone Protector from the vehicle.

IMPORTANT: Conduct final inspection, ensuring all fasteners are tightened, and clips are correctly installed and not touching painted surfaces. Close the bonnet and check clearances at all edges for interference and adjust if necessary.